



| Key & Keyway Dimensions - Millimeters | | | | | | | | | | |
|---------------------------------------|------|------------------|------------|----------------------|---------|---------|-----------------------|------|---------------------|------|
| Shaft Diameter "D" | | Key Size Nominal | | Keyway Width Hub "W" | | | Keyway Depth Hub "T2" | | Keyway Radius "R" † | |
| Over | Thru | Width "W" | Height "H" | Nominal | Min | Max | Min | Max | Min | Max |
| 6 | 8 | 2 | 2 | 2 | -0.0125 | +0.0125 | 1.0 | 1.1 | 0.08 | 0.16 |
| 8 | 10 | 3 | 3 | 3 | -0.0125 | +0.0125 | 1.4 | 1.5 | 0.08 | 0.16 |
| 10 | 12 | 4 | 4 | 4 | -0.0150 | +0.0150 | 1.8 | 1.9 | 0.08 | 0.16 |
| 12 | 17 | 5 | 5 | 5 | -0.0150 | +0.0150 | 2.3 | 2.4 | 0.16 | 0.25 |
| 17 | 22 | 6 | 6 | 6 | -0.0150 | +0.0150 | 2.8 | 2.9 | 0.16 | 0.25 |
| 22 | 30 | 8 | 7 | 8 | -0.0180 | +0.0180 | 3.3 | 3.5 | 0.16 | 0.25 |
| 30 | 38 | 10 | 8 | 10 | -0.0180 | +0.0180 | 3.3 | 3.5 | 0.25 | 0.40 |
| 38 | 44 | 12 | 8 | 12 | -0.0215 | +0.0215 | 3.3 | 3.5 | 0.25 | 0.40 |
| 44 | 50 | 14 | 9 | 14 | -0.0215 | +0.0215 | 3.8 | 4.0 | 0.25 | 0.40 |
| 50 | 58 | 16 | 10 | 16 | -0.0215 | +0.0215 | 4.3 | 4.5 | 0.25 | 0.40 |
| 58 | 65 | 18 | 11 | 18 | -0.0215 | +0.0215 | 4.4 | 4.6 | 0.25 | 0.40 |
| 65 | 75 | 20 | 12 | 20 | -0.0260 | +0.0260 | 4.9 | 5.1 | 0.40 | 0.60 |
| 75 | 85 | 22 | 14 | 22 | -0.0260 | +0.0260 | 5.4 | 5.6 | 0.40 | 0.60 |
| 85 | 95 | 25 | 14 | 25 | -0.0260 | +0.0260 | 5.4 | 5.6 | 0.40 | 0.60 |
| 95 | 110 | 28 | 16 | 28 | -0.0260 | +0.0260 | 6.4 | 6.6 | 0.40 | 0.60 |
| 110 | 130 | 32 | 18 | 32 | -0.0310 | +0.0310 | 7.4 | 7.6 | 0.40 | 0.60 |
| 130 | 150 | 36 | 20 | 36 | -0.0310 | +0.0310 | 8.4 | 8.7 | 0.70 | 1.00 |
| 150 | 170 | 40 | 22 | 40 | -0.0310 | +0.0310 | 9.4 | 9.7 | 0.70 | 1.00 |
| 170 | 200 | 45 | 25 | 45 | -0.0310 | +0.0310 | 10.4 | 10.7 | 0.70 | 1.00 |
| 200 | 230 | 50 | 28 | 50 | -0.0310 | +0.0310 | 11.4 | 11.7 | 0.70 | 1.00 |
| 230 | 260 | 56 | 32 | 56 | -0.0370 | +0.0370 | 12.4 | 12.7 | 1.20 | 1.60 |
| 260 | 290 | 63 | 32 | 63 | -0.0370 | +0.0370 | 12.4 | 12.7 | 1.20 | 1.60 |
| 290 | 330 | 70 | 36 | 70 | -0.0370 | +0.0370 | 14.4 | 14.7 | 1.20 | 1.60 |
| 330 | 380 | 80 | 40 | 80 | -0.0370 | +0.0370 | 15.4 | 15.7 | 2.00 | 2.50 |
| 380 | 440 | 90 | 45 | 90 | -0.0435 | +0.0435 | 17.4 | 17.7 | 2.00 | 2.50 |
| 440 | 500 | 100 | 50 | 100 | -0.0435 | +0.0435 | 19.5 | 19.8 | 2.00 | 2.50 |

Keyways will be furnished per ISO/R773 and Js9 width tolerance unless otherwise specified. (Dimensions comply with DIN 6885/1)

† Requires the use of chamfered keys

Surface Finish — Sides and bottom of keyways shall not exceed 250 micro inches.

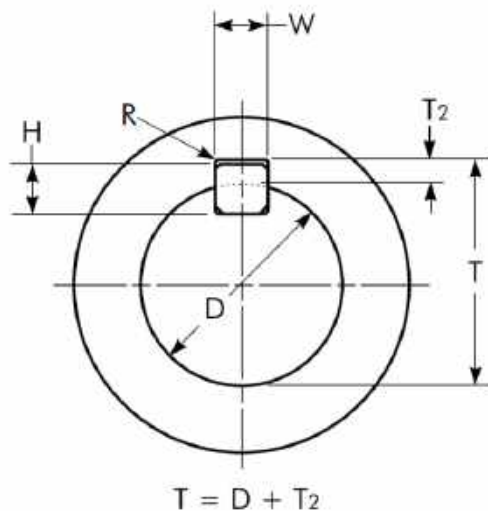



| Key & Keyway Dimensions - Millimeters | | | | | | | | | | |
|---------------------------------------|------|------------------|------------|----------------------|--------|--------|-----------------------|-------|---------------------|------|
| Shaft Diameter "D" | | Key Size Nominal | | Keyway Width Hub "W" | | | Keyway Depth Hub "T2" | | Keyway Radius "R" † | |
| Over | Thru | Width "W" | Height "H" | Nominal | Min | Max | Min | Max | Min | Max |
| 6 | 8 | 2 | 2 | 2 | -0.031 | -0.006 | 1.00 | 1.10 | 0.08 | 0.16 |
| 8 | 10 | 3 | 3 | 3 | -0.031 | -0.006 | 1.40 | 1.50 | 0.08 | 0.16 |
| 10 | 12 | 4 | 4 | 4 | -0.042 | -0.012 | 1.80 | 1.90 | 0.08 | 0.16 |
| 12 | 17 | 5 | 5 | 5 | -0.042 | -0.012 | 2.30 | 2.40 | 0.16 | 0.25 |
| 17 | 22 | 6 | 6 | 6 | -0.042 | -0.012 | 2.80 | 2.90 | 0.16 | 0.25 |
| 22 | 30 | 8 | 7 | 8 | -0.051 | -0.015 | 3.30 | 3.50 | 0.16 | 0.25 |
| 30 | 38 | 10 | 8 | 10 | -0.051 | -0.015 | 3.30 | 3.50 | 0.25 | 0.40 |
| 38 | 44 | 12 | 8 | 12 | -0.061 | -0.018 | 3.30 | 3.50 | 0.25 | 0.40 |
| 44 | 50 | 14 | 9 | 14 | -0.061 | -0.018 | 3.80 | 4.00 | 0.25 | 0.40 |
| 50 | 58 | 16 | 10 | 16 | -0.061 | -0.018 | 4.30 | 4.50 | 0.25 | 0.40 |
| 58 | 65 | 18 | 11 | 18 | -0.061 | -0.018 | 4.40 | 4.60 | 0.25 | 0.40 |
| 65 | 75 | 20 | 12 | 20 | -0.074 | -0.022 | 4.90 | 5.10 | 0.40 | 0.60 |
| 75 | 85 | 22 | 14 | 22 | -0.074 | -0.022 | 5.40 | 5.60 | 0.40 | 0.60 |
| 85 | 95 | 25 | 14 | 25 | -0.074 | -0.022 | 5.40 | 5.60 | 0.40 | 0.60 |
| 95 | 110 | 28 | 16 | 28 | -0.074 | -0.022 | 6.40 | 6.60 | 0.40 | 0.60 |
| 110 | 130 | 32 | 18 | 32 | -0.088 | -0.026 | 7.40 | 7.60 | 0.40 | 0.60 |
| 130 | 150 | 36 | 20 | 36 | -0.088 | -0.026 | 8.40 | 8.70 | 0.70 | 1.00 |
| 150 | 170 | 40 | 22 | 40 | -0.088 | -0.026 | 9.40 | 9.70 | 0.70 | 1.00 |
| 170 | 200 | 45 | 25 | 45 | -0.088 | -0.026 | 10.40 | 10.70 | 0.70 | 1.00 |
| 200 | 230 | 50 | 28 | 50 | -0.088 | -0.026 | 11.40 | 11.70 | 0.70 | 1.00 |
| 230 | 260 | 56 | 32 | 56 | -0.106 | -0.032 | 12.40 | 12.70 | 1.20 | 1.60 |
| 260 | 290 | 63 | 32 | 63 | -0.106 | -0.032 | 12.40 | 12.70 | 1.20 | 1.60 |
| 290 | 330 | 70 | 36 | 70 | -0.106 | -0.032 | 14.40 | 14.70 | 1.20 | 1.60 |
| 330 | 380 | 80 | 40 | 80 | -0.106 | -0.032 | 15.40 | 15.70 | 2.00 | 2.50 |
| 380 | 440 | 90 | 45 | 90 | -0.124 | -0.037 | 17.40 | 17.70 | 2.00 | 2.50 |
| 440 | 500 | 100 | 50 | 100 | -0.124 | -0.037 | 19.50 | 19.80 | 2.00 | 2.50 |

Keyways will be furnished with P9 width tolerance only upon request. (Dimensions comply with DIN 6885/1)

†Requires use of chamfered keys.



| Key & Keyway Dimensions - Millimeters | | | | | | | | | | |
|---------------------------------------|------|------------------|------------|----------------------|--------|--------|-----------------------|------|---------------------|------|
| Shaft Diameter "D" | | Key Size Nominal | | Keyway Width Hub "W" | | | Keyway Depth Hub "T2" | | Keyway Radius "R" ‡ | |
| Over | Thru | Width "W" | Height "H" | Nominal | Min | Max | Min | Max | Min | Max |
| 6 | 8 | 2 | 2 | 2 | +0.020 | +0.060 | 1.0 | 1.1 | 0.08 | 0.16 |
| 8 | 10 | 3 | 3 | 3 | +0.020 | +0.060 | 1.4 | 1.5 | 0.08 | 0.16 |
| 10 | 12 | 4 | 4 | 4 | +0.030 | +0.078 | 1.8 | 1.9 | 0.08 | 0.16 |
| 12 | 17 | 5 | 5 | 5 | +0.030 | +0.078 | 2.3 | 2.4 | 0.16 | 0.25 |
| 17 | 22 | 6 | 6 | 6 | +0.030 | +0.078 | 2.8 | 2.9 | 0.16 | 0.25 |
| 22 | 30 | 8 | 7 | 8 | +0.040 | +0.098 | 3.3 | 3.5 | 0.16 | 0.25 |
| 30 | 38 | 10 | 8 | 10 | +0.040 | +0.098 | 3.3 | 3.5 | 0.25 | 0.40 |
| 38 | 44 | 12 | 8 | 12 | +0.050 | +0.120 | 3.3 | 3.5 | 0.25 | 0.40 |
| 44 | 50 | 14 | 9 | 14 | +0.050 | +0.120 | 3.8 | 4.0 | 0.25 | 0.40 |
| 50 | 58 | 16 | 10 | 16 | +0.050 | +0.120 | 4.3 | 4.5 | 0.25 | 0.40 |
| 58 | 65 | 18 | 11 | 18 | +0.050 | +0.120 | 4.4 | 4.6 | 0.25 | 0.40 |
| 65 | 75 | 20 | 12 | 20 | +0.065 | +0.149 | 4.9 | 5.1 | 0.40 | 0.60 |
| 75 | 85 | 22 | 14 | 22 | +0.065 | +0.149 | 5.4 | 5.6 | 0.40 | 0.60 |
| 85 | 95 | 25 | 14 | 25 | +0.065 | +0.149 | 5.4 | 5.6 | 0.40 | 0.60 |
| 95 | 110 | 28 | 16 | 28 | +0.065 | +0.149 | 6.4 | 6.6 | 0.40 | 0.60 |
| 110 | 130 | 32 | 18 | 32 | +0.080 | +0.180 | 7.4 | 7.6 | 0.40 | 0.60 |
| 130 | 150 | 36 | 20 | 36 | +0.080 | +0.180 | 8.4 | 8.7 | 0.70 | 1.00 |
| 150 | 170 | 40 | 22 | 40 | +0.080 | +0.180 | 9.4 | 9.7 | 0.70 | 1.00 |
| 170 | 200 | 45 | 25 | 45 | +0.080 | +0.180 | 10.4 | 10.7 | 0.70 | 1.00 |
| 200 | 230 | 50 | 28 | 50 | +0.080 | +0.180 | 11.4 | 11.7 | 0.70 | 1.00 |
| 230 | 260 | 56 | 32 | 56 | +0.100 | +0.220 | 12.4 | 12.7 | 1.20 | 1.60 |
| 260 | 290 | 63 | 32 | 63 | +0.100 | +0.220 | 12.4 | 12.7 | 1.20 | 1.60 |
| 290 | 330 | 70 | 36 | 70 | +0.100 | +0.220 | 14.4 | 14.7 | 1.20 | 1.60 |
| 330 | 380 | 80 | 40 | 80 | +0.100 | +0.220 | 15.4 | 15.7 | 2.00 | 2.50 |
| 380 | 440 | 90 | 45 | 90 | +0.120 | +0.260 | 17.4 | 17.7 | 2.00 | 2.50 |
| 440 | 500 | 100 | 50 | 100 | +0.120 | +0.260 | 19.5 | 19.8 | 2.00 | 2.50 |

Keyways will be furnished with D10 width tolerance only upon request. (Dimensions with DIN 6885/1)

‡ Requires use of chamfered keys.



| Nominal Bore | | Key Size | | Keyway Size | | | | | | |
|--------------|--------|-----------------|---|---------------|----------------|----------------|-----------------------|-----------------|-------|------|
| Over | Thru | Width x Height | Suggested Chamfer for Standard Filleted Keyways 45°(+.005-.000) | Width x Depth | Tolerance | | Optional Fillet Radii | | | |
| | | | | | Width | Depth | Standard † | Alternate | | |
| 0.4375 | 0.5625 | 0.125 x 0.125 | 0.031 (1/32) | Broached | 0.125 x 0.062 | +0.0020-0.0000 | +0.010 to +.020 | 0.016 | | |
| 0.5625 | 0.875 | 0.1875 x 0.1875 | 0.031 (1/32) | | 0.1875 x 0.094 | +0.0020-0.0000 | +0.010 to +.020 | 0.016 | 0.031 | |
| 0.875 | 1.250 | 0.250 x 0.250 | 0.031 (1/32) | | 0.250 x 0.125 | +0.0020-0.0000 | +0.010 to +.020 | 0.016 | 0.031 | |
| 1.250 | 1.375 | 0.3125 x 0.3125 | 0.047 (3/64) | | 0.3125 x 0.156 | +0.0020-0.0000 | +0.010 to +.020 | 0.031 | | |
| 1.375 | 1.750 | 0.375 x 0.375 | 0.047 (3/64) | | 0.375 x 0.188 | +0.0025-0.0000 | +0.010 to +.020 | 0.031 | 0.062 | |
| 1.750 | 2.250 | 0.500 x 0.500 | 0.047 (3/64) | | 0.500 x 0.250 | +0.0025-0.0000 | +0.010 to +.020 | 0.031 | 0.062 | |
| 2.250 | 2.750 | 0.625 x 0.625 | 0.078 (5/64) | | 0.625 x 0.312 | +0.0030-0.0000 | +0.010 to +.020 | 0.062 | 0.031 | |
| 2.750 | 3.250 | 0.750 x 0.750 | 0.078 (5/64) | | 0.750 x 0.375 | +0.0030-0.0000 | +0.010 to +.020 | 0.062 | 0.031 | |
| 3.250 | 3.750 | 0.875 x 0.875 | 0.078 (5/64) | | 0.875 x 0.438 | +0.0030-0.0000 | +0.010 to +.020 | 0.062 | 0.031 | |
| 3.750 | 4.500 | 1.000 x 1.000 | 0.078 (5/64) | | 1.000 x 0.500 | +0.0030-0.0000 | +0.010 to +.020 | 0.062 | | |
| 4.500 | 5.500 | 1.250 x 1.250 | 0.156 (5/32) | | 1.250 x 0.625 | +0.0035-0.0000 | +0.010 to +.020 | 0.125 | 0.062 | |
| 5.500 | 6.500 | 1.500 x 1.500 | 0.156 (5/32) | | 1.500 x 0.750 | +0.0035-0.0000 | +0.010 to +.020 | 0.125 | 0.062 | |
| 6.500 | 7.500 | 1.750 x 1.500 | 0.156 (5/32) | | 1.750 x 0.750 | +0.0040-0.0000 | +0.010 to +.020 | 0.125 | | |
| 7.500 | 9.000 | 2.000 x 1.500 | 0.156 (5/32) | | 2.000 x 0.750 | +0.0040-0.0000 | +0.010 to +.020 | 0.125 | | |
| 9.000 | 11.000 | 2.500 x 1.750 | 0.156 (5/32) | | Keyseated | 2.500 x 0.875 | +0.0045-0.0000 | +0.010 to +.020 | 0.125 | |
| 11.000 | 13.000 | 3.000 x 2.000 | 0.219 (7/32) | | | 3.000 x 1.000 | +0.0045-0.0000 | +0.010 to +.020 | 0.188 | |
| 13.000 | 15.000 | 3.500 x 2.500 | 0.219 (7/32) | 3.500 x 1.250 | | +0.0050-0.0000 | +0.010 to +.020 | 0.188 | | |
| 15.000 | 18.000 | 4.000 x 3.000 | 0.281 (9/32) | 4.000 x 1.500 | | +0.0050-0.0000 | +0.010 to +.020 | 0.250 | | |
| 18.000 | 22.000 | 5.000 x 3.500 | 0.281 (9/32) | 5.000 x 1.750 | | +0.0060-0.0000 | +0.010 to +.020 | 0.250 | | |
| 22.000 | 26.000 | 6.000 x 4.000 | 0.406 (13/32) | 6.000 x 2.000 | | +0.0060-0.0000 | +0.010 to +.020 | 0.375 | | |
| 26.000 | 30.000 | 7.000 x 5.000 | 0.406 (13/32) | 7.000 x 2.500 | | +0.0060-0.0000 | +0.010 to +.020 | 0.375 | | |

All sizes are in inches.

Shallow keyway depths must exceed 2/3 of the full keyway depth of the square keys shown above.

† Fillet radii comply with AGMA 9002-A86.