

Coupling Size	D1	D2	D3 Max	D4	D5	D6 Max	D7	D8	L1	L2 - DBSE Min. mm	L3
CK8-155	155	116	82	106	143	110	161	209	84	130	110
CK8-185	185	143	100	127	167	134	187	235	100	148	134
CK8-209	209	161	110	143	185	148	208	262	110	169	148
CK8-235	235	187	134	167	185	148	208	262	134	183	148
CK8-262	262	208	148	185	200	161	225	288	148	207	161
CK8-288	288	225	161	200	229	184	255	318	161	229	166
CK8-318	318	255	184	229	-	-	-	-	166	241	-
CK8-342	342	286	212	257	-	-	-	-	191	255	-
CK8-371	371	315	235	285	-	-	-	-	212	273	-
CK8-417	417	354	260	320	-	-	-	-	234	303	-
CK8-465	465	402	290	365	-	-	-	-	261	345	-
CK8-529	529	464	330	424	-	-	-	-	297	381	-
CK8-611	611	546	420	503	-	-	-	-	378	422	-
CK8-653	653	588	446	538	-	-	-	-	401	457	-
CK8-761	761	696	520	632	-	-	-	-	468	533	-
CK8-834	834	769	580	695	-	-	-	-	522	587	-

Coupling Size	Rating kW/1000 rpm	Max. Continuous Torque kNm	Peak Overload Torque kNm	Max Speed - Rpm		Weight - Transmission Unit		Weight - Unbored Hub	
				Std Hub	Large Hub	Kg @ Min. DBSE	Extra DBSE Kg/m	Standard Hub Kg	Large Hub Kg
CK8-155	300	2.9	5.8	15,300	11,300	8.6	16.2	8	21.9
CK8-185	500	4.8	9.6	12,800	10,100	13.6	21.7	14	34.3
CK8-209	750	7.1	14.2	11,300	9,000	19.5	27.2	19	46.6
CK8-235	1,050	10.0	20.0	10,100	9,000	27.9	34.0	31	45.5
CK8-262	1,500	14.3	28.6	9,000	8,200	37.5	41.8	42	58.0
CK8-288	2,000	19.1	38.2	8,200	7,400	49.0	49.0	54	77.0
CK8-318	2,600	24.8	49.6	7,400	-	66.0	60.0	71	-
CK8-342	3,350	32.0	64.0	6,900	-	80.0	68.0	101	-
CK8-371	4,250	40.5	81.0	6,300	-	105.0	81.0	135	-
CK8-417	6,010	57.3	115.0	5,600	-	147.0	101.0	189	-
CK8-465	8,500	81.0	162.0	5,000	-	212.0	132.0	269	-
CK8-529	13,000	124.0	248.0	4,200	-	340.0	169.0	406	-
CK8-611	17,000	162.0	324.0	3,800	-	454.0	203.0	709	-
CK8-653	21,000	200.0	400.0	3,600	-	547.0	234.0	873	-
CK8-761	36,000	344.0	688.0	3,050	-	867.0	328.0	1,423.0	-
CK8-834	49,000	468.0	936.0	2,800	-	1,153.0	403.0	1,934.0	-

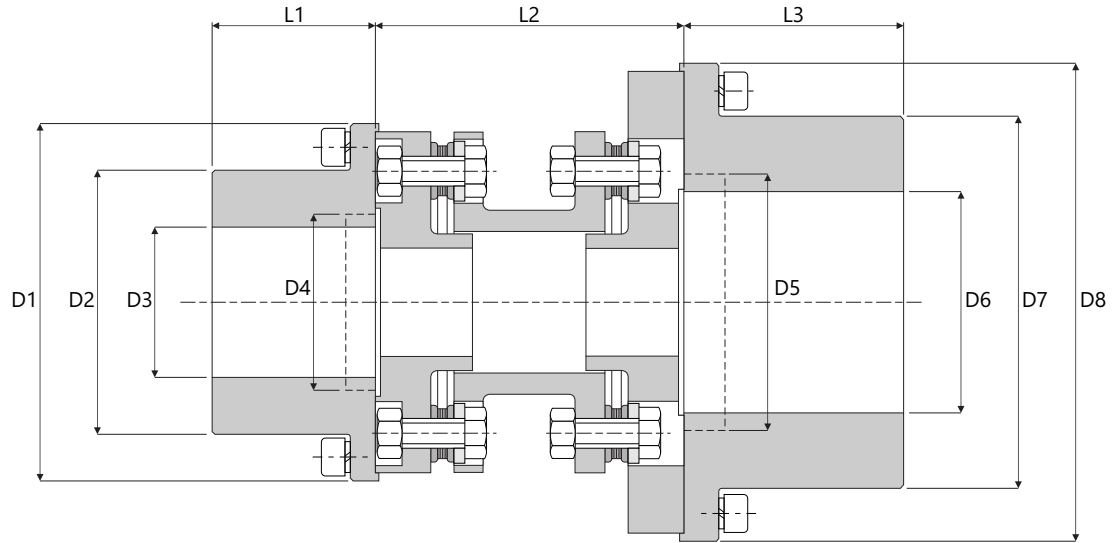

Coupling Size	D1	D2	D3 Max	D4	D5	D6 Max	D7	D8	L1	* L2 - DBSE Min. in.	L3
CK8-155	6.102"	4.567"	3.228"	4.173"	5.630"	4.331"	6.339"	8.228"	3.307"	5.118"	4.331"
CK8-185	7.283"	5.630"	3.937"	5.000"	6.575"	5.276"	7.362"	9.252"	3.937"	5.827"	5.276"
CK8-209	8.228"	6.339"	4.331"	5.630"	7.283"	5.827"	8.189"	10.315"	4.331"	6.654"	5.827"
CK8-235	9.252"	7.362"	5.276"	6.575"	7.283"	5.827"	8.189"	10.315"	5.276"	7.205"	5.827"
CK8-262	10.315"	8.189"	5.827"	7.283"	7.874"	6.339"	8.858"	11.339"	5.827"	8.150"	6.339"
CK8-288	11.339"	8.858"	6.339"	7.874"	9.016"	7.244"	10.039"	12.520"	6.339"	9.016"	6.535"
CK8-318	12.520"	10.039"	7.244"	9.016"	-	-	-	-	6.535"	9.488"	-
CK8-342	13.465"	11.260"	8.346"	10.118"	-	-	-	-	7.520"	10.039"	-
CK8-371	14.606"	12.402"	9.252"	11.220"	-	-	-	-	8.346"	10.748"	-
CK8-417	16.417"	13.937"	10.236"	12.598"	-	-	-	-	9.213"	11.929"	-
CK8-465	18.307"	15.827"	11.417"	14.370"	-	-	-	-	10.276"	13.583"	-
CK8-529	20.827"	18.268"	12.992"	16.693"	-	-	-	-	11.693"	15.000"	-
CK8-611	24.055"	21.496"	16.535"	19.803"	-	-	-	-	14.882"	16.614"	-
CK8-653	25.709"	23.150"	17.559"	21.181"	-	-	-	-	15.787"	17.992"	-
CK8-761	29.961"	27.402"	20.472"	24.882"	-	-	-	-	18.425"	20.984"	-
CK8-834	32.835"	30.276"	22.835"	27.362"	-	-	-	-	20.551"	23.110"	-

Coupling Size	Rating HP/100 rpm	Max. Continuous Torque lb.in.	Peak Overload Torque lb.in.	Max Speed - Rpm		Weight - Transmission Unit		Weight - Unbored Hub	
				Std Hub	Large Hub	lb. @ Min. DBSE	Extra DBSE lb/in.	Standard Hub lb.	Large Hub lb.
CK8-155	40	25,350	50,700	15,300	11,300	19	0.9	17.6	48.3
CK8-185	67	42,250	84,500	12,800	10,100	30	1.2	30.2	75.6
CK8-209	101	63,400	126,800	11,300	9,000	43	1.5	42.5	102.7
CK8-235	141	88,750	177,500	10,100	9,000	61.5	1.9	68.6	100.3
CK8-262	201	126,750	253,500	9,000	8,200	82.7	2.3	93	127.9
CK8-288	268	169,050	338,100	8,200	7,400	108	2.7	119	169.8
CK8-318	349	219,750	439,500	7,400	-	145.5	3.4	156.5	-
CK8-342	449	283,150	566,300	6,900	-	176.4	3.8	222.7	-
CK8-371	570	359,250	718,500	6,300	-	231.5	4.5	297.6	-
CK8-417	806	507,900	1,015,800	5,600	-	324.1	5.7	416.7	-
CK8-465	1,140	718,400	1,436,800	5,000	-	467.4	7.4	593	-
CK8-529	1,743	1,098,700	2,197,400	4,200	-	749.6	9.5	895.1	-
CK8-611	2,280	1,436,800	2,873,600	3,800	-	1000.9	11.4	1563.1	-
CK8-653	2,816	1,774,850	3,549,700	3,600	-	1205.9	13.1	1924.6	-
CK8-761	4,828	3,042,450	6,084,900	3,050	-	1911.4	18.4	3137.2	-
CK8-834	6,571	4,141,300	8,282,600	2,800	-	2541.9	22.6	4263.7	-